

NATR8-X

Yoke type track roller

Schaeffler ID:
0000344010000

Yoke type track rollers NATR, with axial guidance, gap seals on both sides

Technical information

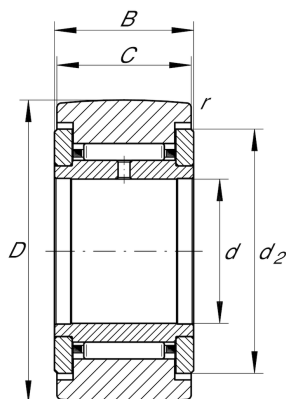

Main Dimensions & Performance Data

| | | |
|--------------|-------------|---|
| d | 8 mm | Bore diameter |
| D | 24 mm | Outside diameter |
| B | 15 mm | Width, inner ring |
| $C_{r w}$ | 5,500 N | Basic dynamic load rating, radial |
| $C_{0r w}$ | 6,700 N | Basic static load rating, radial |
| $C_{ur w}$ | 940 N | Fatigue load limit, radial |
| n_{DG} | 7,500 1/min | Speed on permanent grease lubrication |
| $F_{0r per}$ | 6,700 N | Permissible static load, radial |
| $F_{r per}$ | 6,700 N | Permissible dynamic load outer ring, radial |
| | 0.04 kg | Weight |

Dimensions

| | | |
|-----------|--------|--------------------------------------|
| C | 14 mm | Width, outer ring |
| d_2 | 19 mm | Outside diameter of thrust washer |
| r_{min} | 0.3 mm | Minimum chamfer dimension |
| R | 500 mm | Radius of outer ring outside profile |